

NEW GENERATION

Bradford™  
soundscreen™



*We call it SoundScreen.  
You'll call it heaven.*

Just quietly... there is no better  
way to screen sound.

INDUSTRIAL STRENGTH  
ACOUSTIC INSULATION

CSR



SoundScreen™ is Australia's most trusted acoustic insulation because of its proven performance. Builders large and small know that wall systems that incorporate SoundScreen will deliver on the fundamental requirement to screen sound out.

CSR Bradford™ has now improved this product and developed NEW GENERATION SoundScreen. New fiberising technology has been used to deliver even better sound attenuation properties. Testing of NEW GENERATION SoundScreen shows an improvement of around 1 Rw in common wall systems.

#### System Acoustic Performance SoundScreen

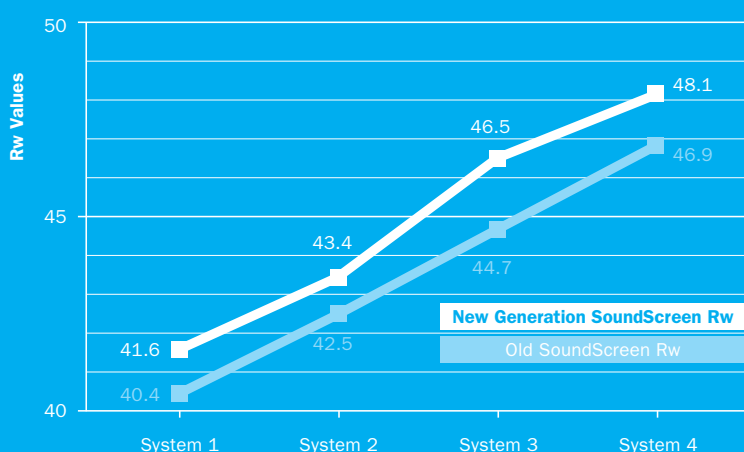

System 1 – 90mm Timber stud with 70mm SoundScreen and 1 x 10mm Standard CSR Gyprock Plasterboard both sides

System 2 – 64mm Steel stud with 60mm SoundScreen and 1 x 13mm Standard CSR Gyprock Plasterboard both sides

System 3 – 76mm Steel stud with 60mm SoundScreen and 1 x 13mm CSR Fyrchek Plasterboard both sides

System 4 – 76mm Steel stud with 70mm SoundScreen and 1 x 13mm CSR Fyrchek Plasterboard both sides

#### MADE FROM NEW GENERATION FIBRE TECHNOLOGY

Bradford SoundScreen has long been regarded by architects and builders as the industry standard for acoustic insulation. Now with improved acoustic performance there's no better way to screen sound from your home.

## NOISE DOES ANNOY

Doctors and psychologists agree that noise has the ability to raise stress, disrupt sleep and generally reduce your quality of life.

There are a lot of reasons for the growing problem of noise pollution.

We have been subjected to increases in external noise from aircraft and traffic activity. Smaller blocks with larger houses also mean our neighbours are closer. Plus, there are increased noise levels within the home due to higher proportion of hard surfaces, open plan living, more powerful home theatre systems, ensuite bathroom and the ever growing number of appliances within the average home.

## UNDERSTANDING SOUND

Sound power is measured in decibels (dB) on a logarithmic scale which means that a 3dB reduction is actually a 50% decrease in sound power.

A measure called Weighted Sound Reduction Index (Rw) has been developed to measure the effectiveness of noise reduction in different types of construction.

The higher the Rw value the more noise is absorbed and the quieter your home will be. An increase of one Rw unit is approximately equal to a reduction of one decibel of noise level.

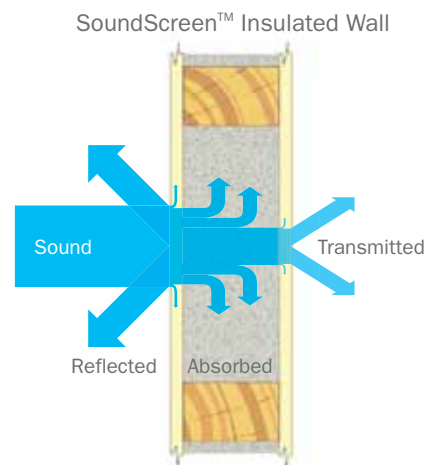

# SoundScreen dramatically reduces unwanted noise through walls and between floors to create a peaceful home

**Acoustic insulation is typically installed in a wall cavity or between a first floor ceiling and second storey floor at the time of construction. Therefore, if you are renovating, adding an extension or building a new house – you should consider NEW GENERATION SoundScreen in the following applications to help localise noise and limit disruption to adjoining rooms:**

- Home theatres
- Study or parent's retreats
- Bathrooms/ensuites
- Laundries
- Home office
- External noise
- Nursery/kids rooms

## KEEP NOISE IN ITS PLACE WITHIN YOUR HOME

Sometimes the worst noise comes from within. Home theatres, excited teenagers and even ensuites can produce noise you would rather not hear around your home.

Including SoundScreen in interior walls can greatly reduce the transmission of noise between rooms allowing you to get the peace and quiet you deserve without cramping the rest of the family's style.

A wall system including SoundScreen can absorb as much as 75% of the sound power to effectively reduce noise to acceptable levels.

SoundScreen is available in thicknesses to suit 70mm and 90mm timber stud sizes. The adjacent diagram shows the reductions that can be achieved using SoundScreen in a 90mm stud wall.

R2.0 (70mm) SoundScreen is also available in 600mm wide to suit metal stud walls.

To achieve even greater reductions replacing the standard plasterboard with a high density acoustic plasterboard is likely to improve the performance by up to an additional 3Rw.

Many factors affect the noise levels in today's modern house:

- The trend towards lighter construction materials
- Open plan living
- Medium density construction
- Small blocks
- Popularity of polished timber floors
- More powerful entertainment systems
- Kids living at home for longer

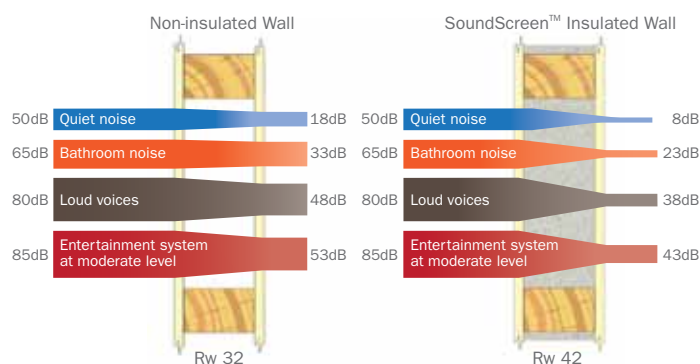

	Stud size	90mm timber studs	90mm timber studs	90mm timber studs
	Insulation	Nil	SoundScreen 70mm	SoundScreen 88mm
	Plasterboard	10mm Gyprock Plasterboard	10mm Gyprock Plasterboard	10mm Gyprock Plasterboard
	Sound absorption performance Rw	32	42	43

# Red noise transfer create peace and quiet.

## STOPPING NOISE ENTERING YOUR HOME

When you come home and close the door you want your home to be a place you and your family can relax without being disturbed by the noise of the world outside.

New fiberising technology gives SoundScreen high levels of sound absorbance while also providing the level of thermal performance required to meet energy efficiency provisions. By including SoundScreen in your external walls you'll reduce traffic noise and potential disturbance from the neighbours.

Australian Standards recommend a level of less than 40 decibels of external sound entering living rooms, and less than 35 decibels entering bedrooms. These levels will allow you to comfortably carry on a conversation, listen to TV at a low volume, and sleep soundly.

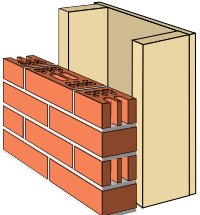

	<b>Brick veneer with 90mm timber studs</b>	No Insulation	Standard	SoundScreen
	<b>Insulation</b>	Nil	R1.5 Gold Insulation	SoundScreen R2.0
	<b>Plasterboard</b>	10mm Gyprock plasterboard	10mm Gyprock plasterboard	10mm Gyprock plasterboard
	<b>Sound absorption performance Rw</b>	52	56	60

## INTERIOR FLOORS

One area often forgotten for sound insulation is between the floors of your home. Airborne noise can travel from the rumpus room to the nursery above or from the kids' bedrooms to the study below. Structural noise of people thumping around on the upstairs floors can be a real annoyance.

Sound impact performance is measured by the amount of noise transferred through the structure. The lower the value of the sound impact performance index, the less noise is transferred through the structure.

SoundScreen included above the internal ground floor ceiling can effectively absorb the airborne elements of the noise while the inclusion of 'isolating resilient mounts' in the ceiling system will greatly reduce the transmission of impact noise.

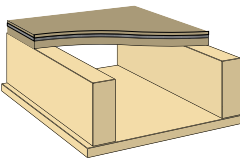

	<b>Carpet on particle flooring on 245mm joists at 600mm centres</b>	Standard	SoundScreen	SoundScreen High Performance
	<b>Insulation</b>	Nil	SoundScreen R2.5	SoundScreen R2.5
	<b>Plasterboard</b>	10mm plasterboard	10mm plasterboard	13mm acoustic plasterboard
	<b>Resilient mount</b>	Nil	Nil	Yes
	<b>Sound absorption performance Rw</b>	39	41	51
	<b>Sound impact performance LnTw</b>	46	43	32

NEW GENERATION



## BREATHE EASY

Bradford is the only approved insulation partner of the National Asthma Council Australia's Sensitive Choice® program. NEW GENERATION SoundScreen is suitable for use in the homes of people with asthma and allergies.



## THE BRADFORD 70 YEAR GUARANTEE

CSR Bradford insulation guarantees that all our products – SoundScreen, Bradford Gold and High Performance insulation, are low allergen, will not pack down, shrink, mould, rot or deteriorate. When installed in accordance with our directions, the products are guaranteed to last at least for 70 years.

SoundScreen technical specifications:

Product	R-Value (m²K/W)	Thickness (mm)	Dimensions (mm)		Product code	Pieces per pack	m² per pack
			Length	Width			
NEW GENERATION SoundScreen R1.7 for walls & floors	R1.7	60	1160	430	114201	10	4.99
	R1.7	60	1160	580	114202	10	6.73
NEW GENERATION SoundScreen R2.0 for walls, floors & ceilings	R2.0	70	1160	430	114206	8	3.99
	R2.0	70	1160	580	114207	8	5.38
	R2.0*	70	1200	600	114177	8	5.76
NEW GENERATION SoundScreen R2.5 for walls, floors & ceilings	R2.5	88	1160	430	114184	6	2.99
	R2.5	88	1160	580	114178	6	4.04
NEW GENERATION SoundScreen R3.1 for floors & ceilings	R3.1	110	1160	430	114251	5	2.49
	R3.1	110	1160	580	114252	5	3.36

\*Suitable for use with metal frame construction.

For more information call **1300 850 305** or visit **[www.soundscreen.com.au](http://www.soundscreen.com.au)**

